

DC Brush Motor & Gear

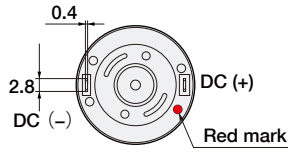

Motor wiring and terminal dimensions diagrams



WP1000 Cutting hole dimensions

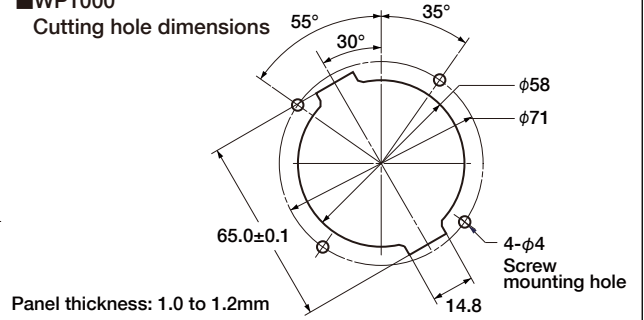

WP10 - □□S

WP10 - □□DS

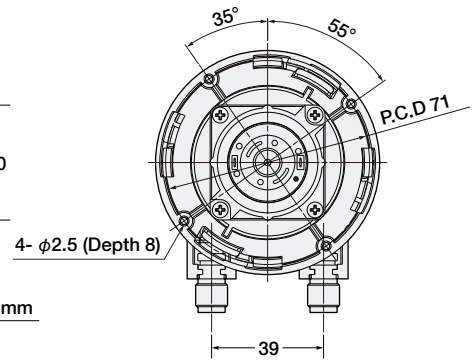
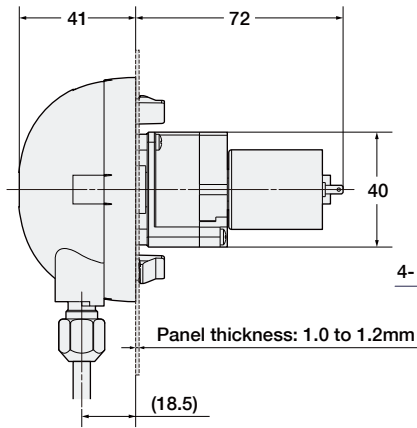
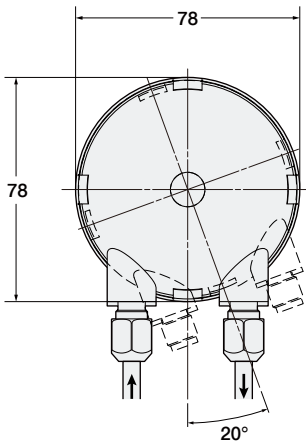

Weight: 185g

WP10 - □□M

WP10 - □□L

WP10 - □□DM

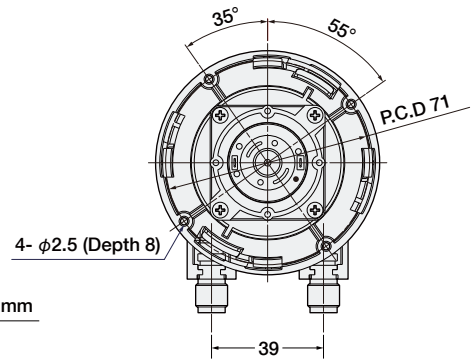
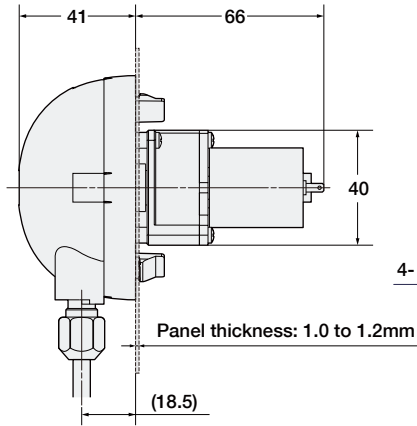
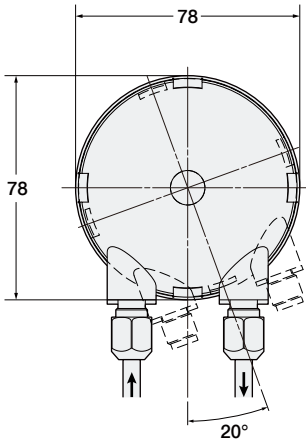

Weight: 178g

WP11 - □□L

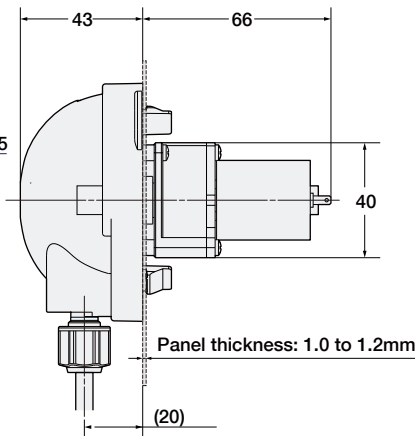
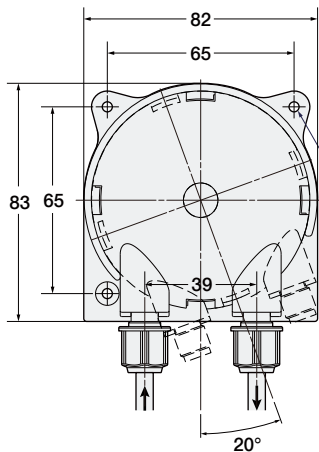

Weight: 186g

WP1000

Cutting hole dimensions

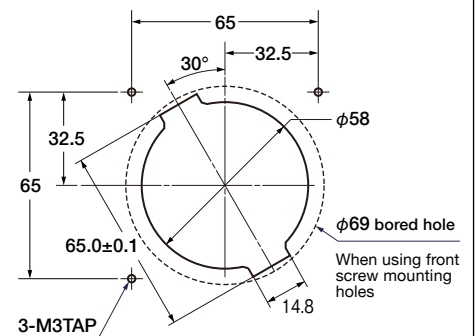

Panel thickness: 1.0 to 1.2mm

Stepper Motor & Gear



BI POLAR Winding Diagram

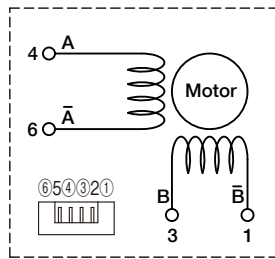

WP1000

Cutting hole dimensions

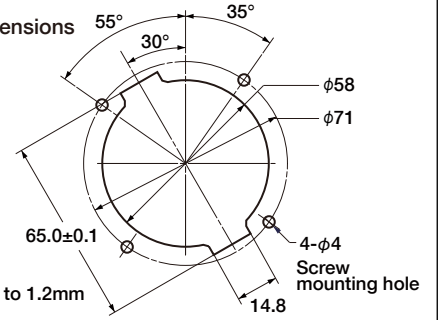

Panel thickness: 1.0 to 1.2mm

WP10 - □□BA

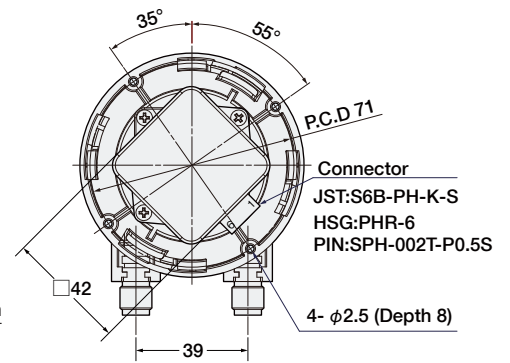
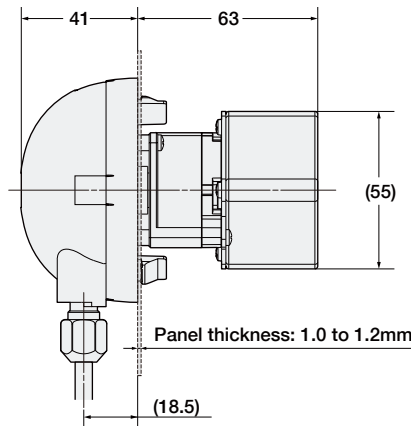
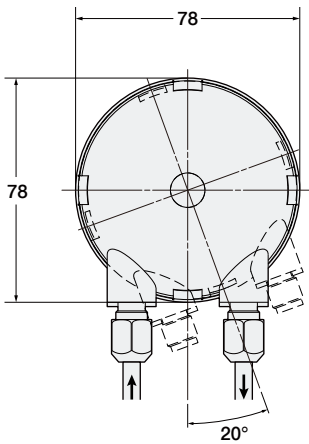

Weight: 322g

WP10 - □□FB

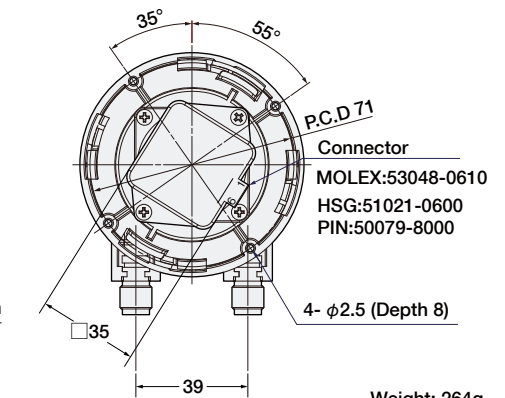
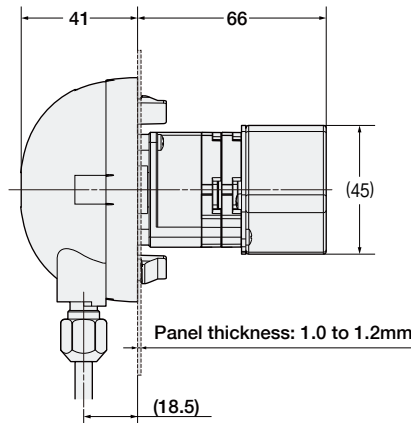
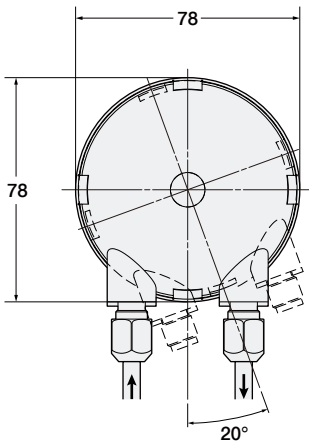

Weight: 264g

WP11 - □□BA

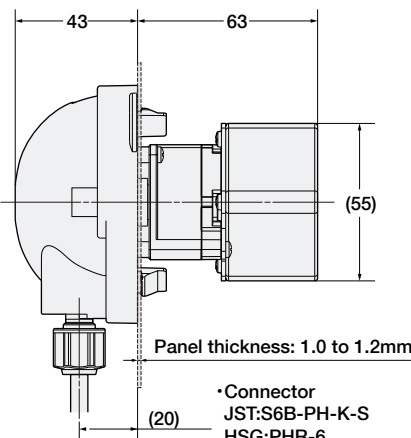
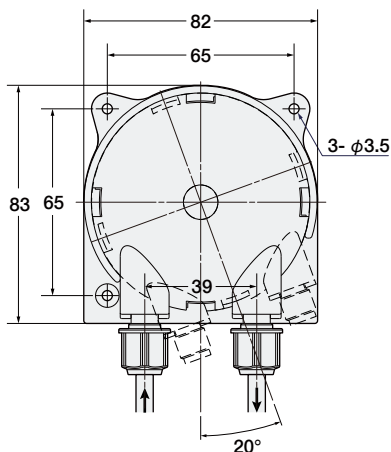

WP1100 Cutting hole dimensions

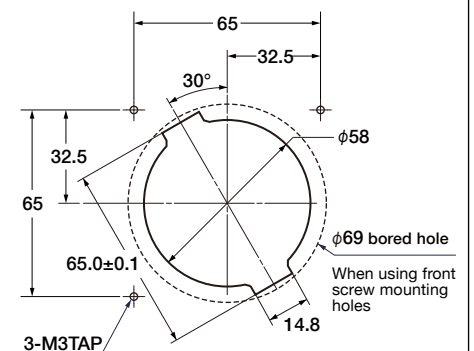

Panel thickness: 1.0 to 1.2mm

Weight: 330g

•Connector
JST:S6B-PH-K-S
HSG:PHR-6
PIN:SPH-002T-P0.5S

DC Brushless Motor & Gear



Motor wiring terminal dimensions diagrams

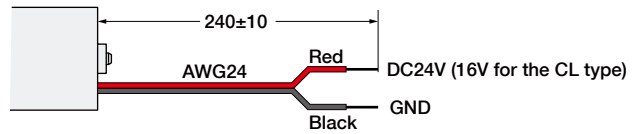

Circuit protection

This motor is not equipped with a circuit for protection against overvoltage and connection to terminals at the incorrect polarity.

Be careful not to apply surge voltages that exceed the rated voltage and not to connect to the incorrect polarity.

WP1000

Cutting hole dimensions

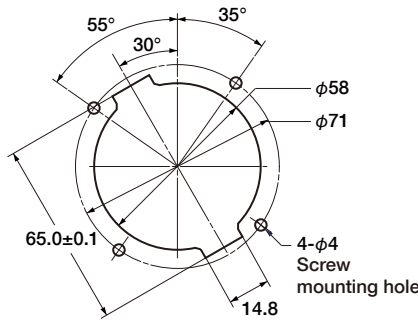

WP1100

Cutting hole dimensions

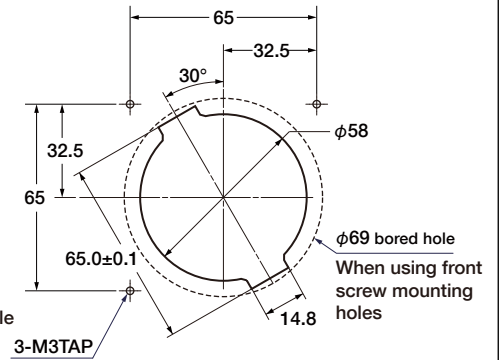

Panel thickness: 1.0 to 1.2mm

WP10 - □□CM

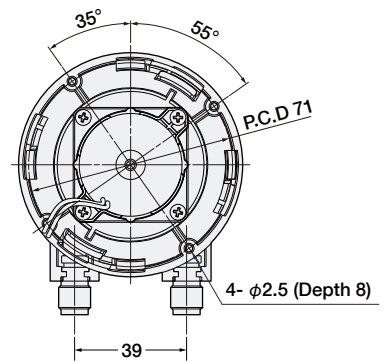
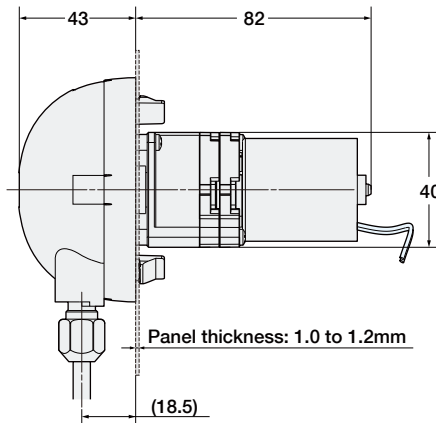
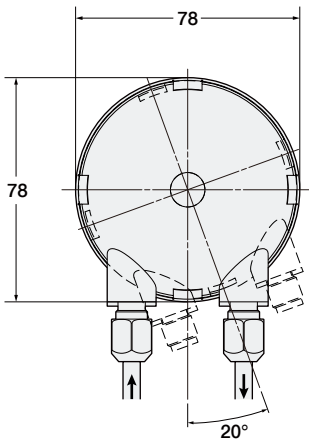

Weight: 290g

WP11 - □□CL

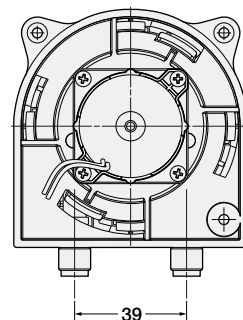
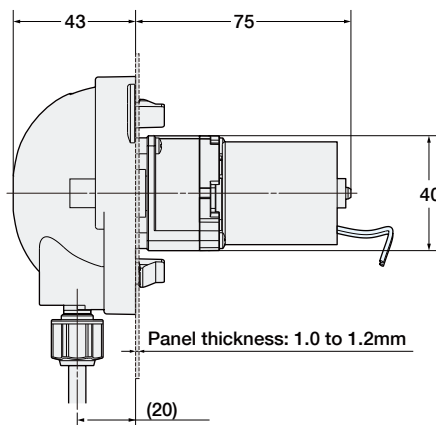
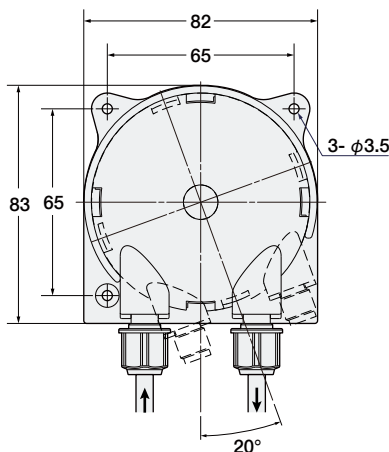

Weight: 290g

AC Synchronous Gear motor



■ Winding Diagram

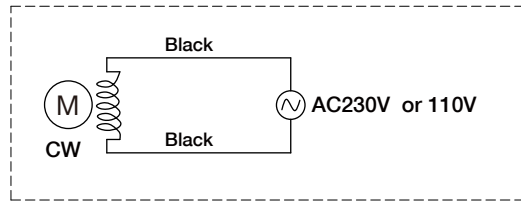

■ Cutting hole dimensions

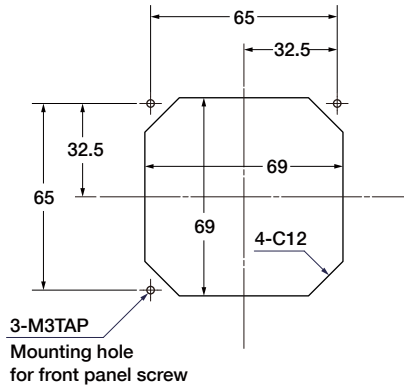

WP11 - □□EE

WP11 - □□EF

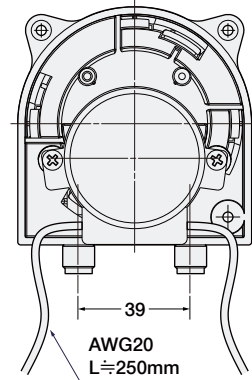
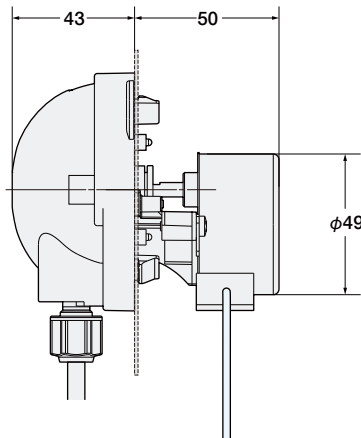
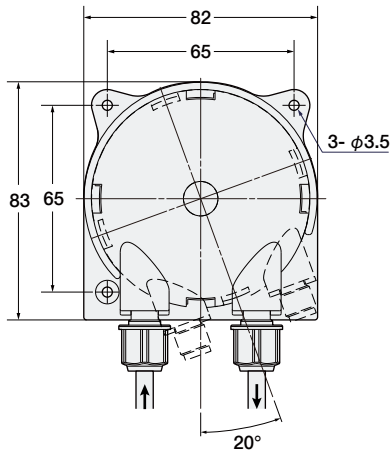

Panel thickness: 1.0 to 1.2mm

Weight: 330g

Using an optional panel



Thickness: 1.2
Material properties: SUS304

